

INSTRUCTION



TF-SB-10X10-16

STEPS

(1) Hardware

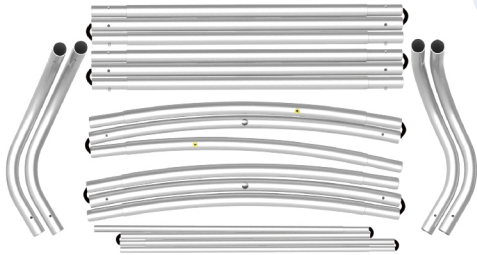

(2) Printed Graphic Fabric Banner (Optional)



STEP 01

Connect to make long poles according to labelings.

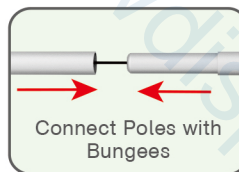
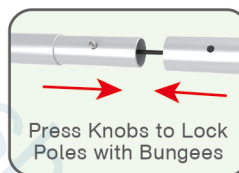
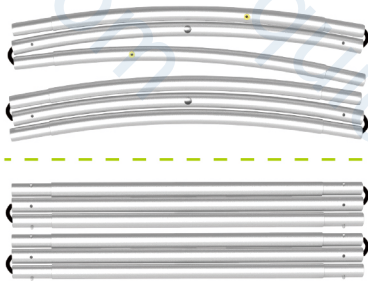

STEP 02

Connect long poles with corner poles according to labelings.

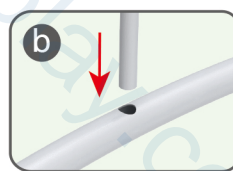
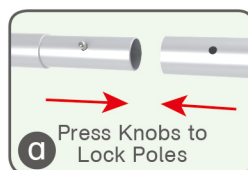
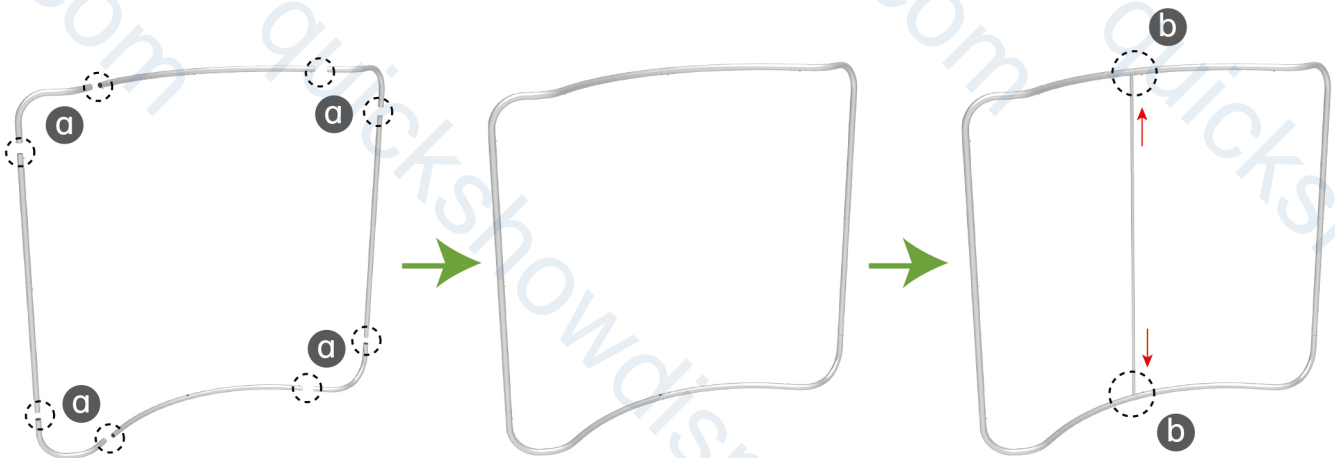

STEPS

STEP 03 Slide fabric banner on frame from top and zip up at bottom.

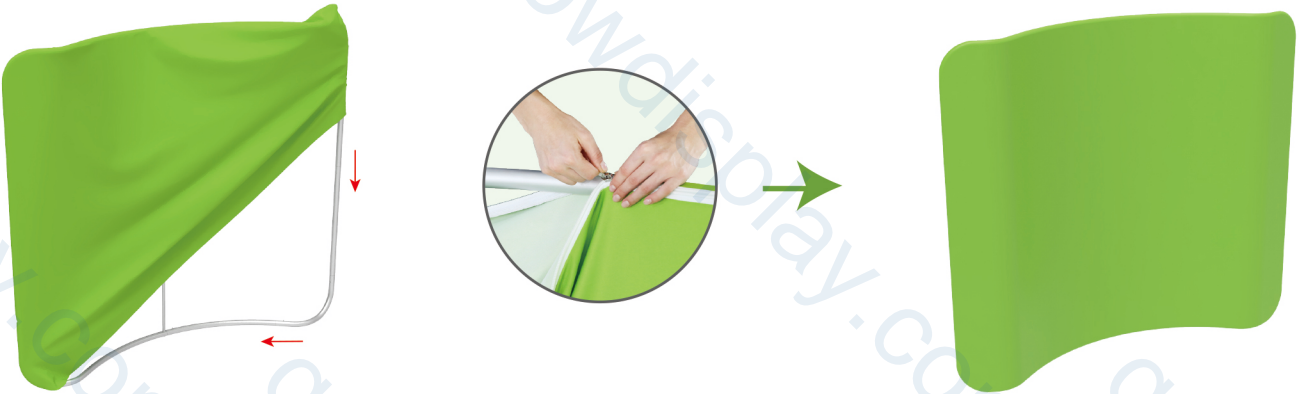

(1) Hardware

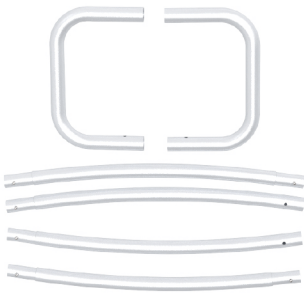

(2) Printed Graphic Fabric Banner (Optional)



STEP 01 Connect poles according to labelings.

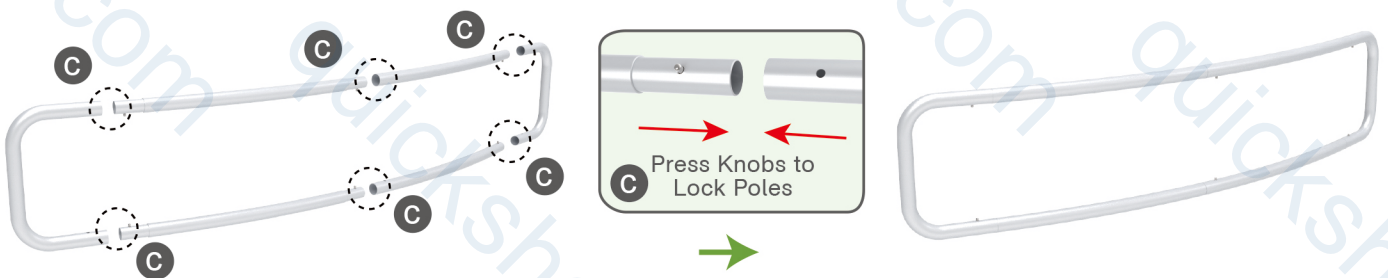

STEP 02 Slide fabric banner on frame from left and zip up at right.



★ One Tool (Hex Wrench) 

STEPS

(1) Hardware

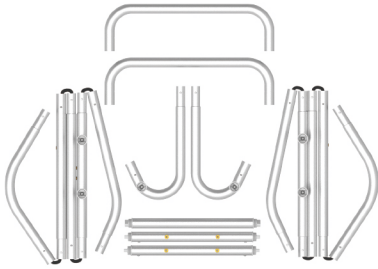

(2) Printed Graphic Fabric Banner (Optional)



STEP 01

Connect to make long poles according to labelings.

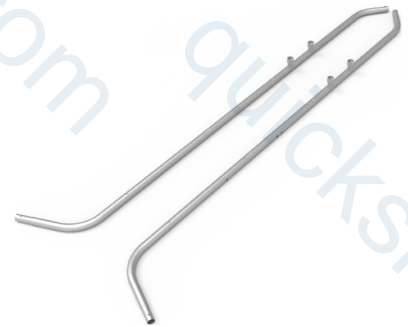
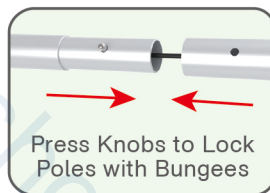

STEP 02

Connect long poles with corner poles according to labelings.

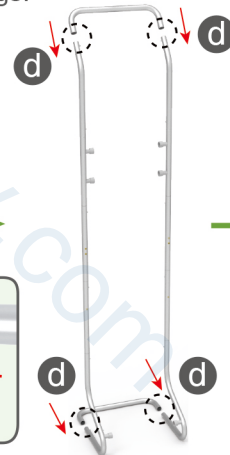
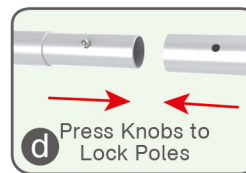
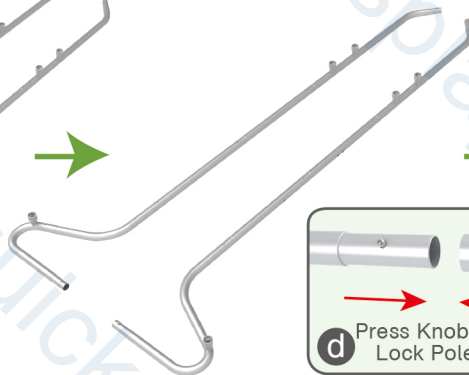
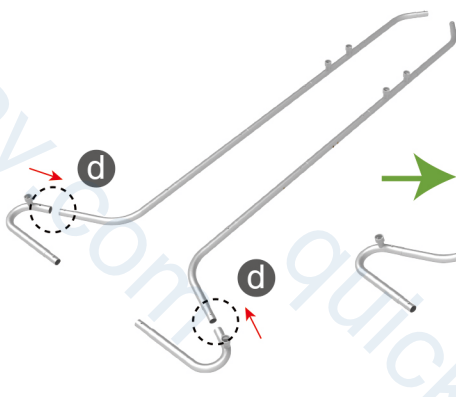

STEP 03

Install cross bars in position.

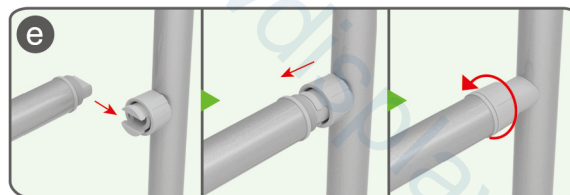

STEPS

STEP 04 Slide fabric banner on frame from top and zip up at bottom.

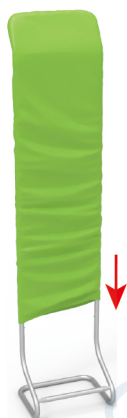

Booth Set Assembly



(1) LED Light & Clip



(2) Shelf & Bracket



(3) 90° C-Shaped Clip & 180° C-Shaped Clip

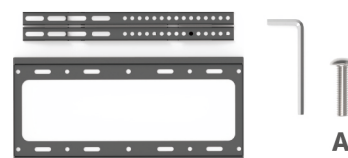

(4) TV Mount & Screw

**STEP 01**

Interconnect display stands with C-shaped clips.

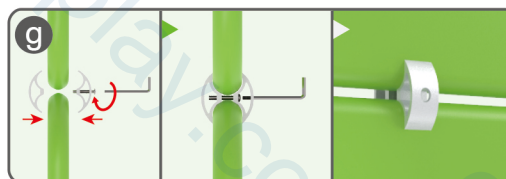
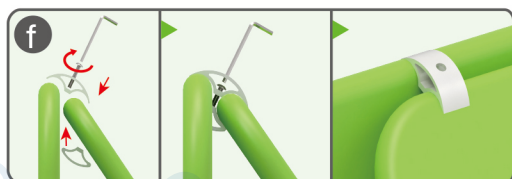
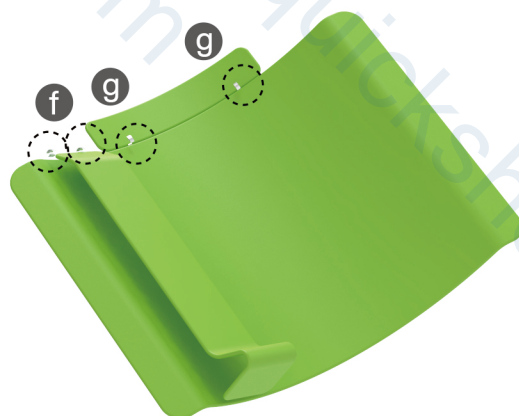

STEP 03

[illegible]

The diagram illustrates the assembly of a display stand. On the left, a main assembly view shows a green stand with a black screen. Two shelves are shown being attached to the stand, with red arrows indicating the direction of movement. The shelves are labeled 'j' and 'k'. In the center, a detailed inset shows the assembly steps. Step 'j' shows a bracket being attached to the stand. Step 'k' shows a shelf being attached to the bracket. On the right, the final assembled stand is shown with two shelves. A green arrow points from the inset to the final assembly.

STEPS

STEP 05 Screw light clips at top of display stands, slide lights onto them and adjust their direction.

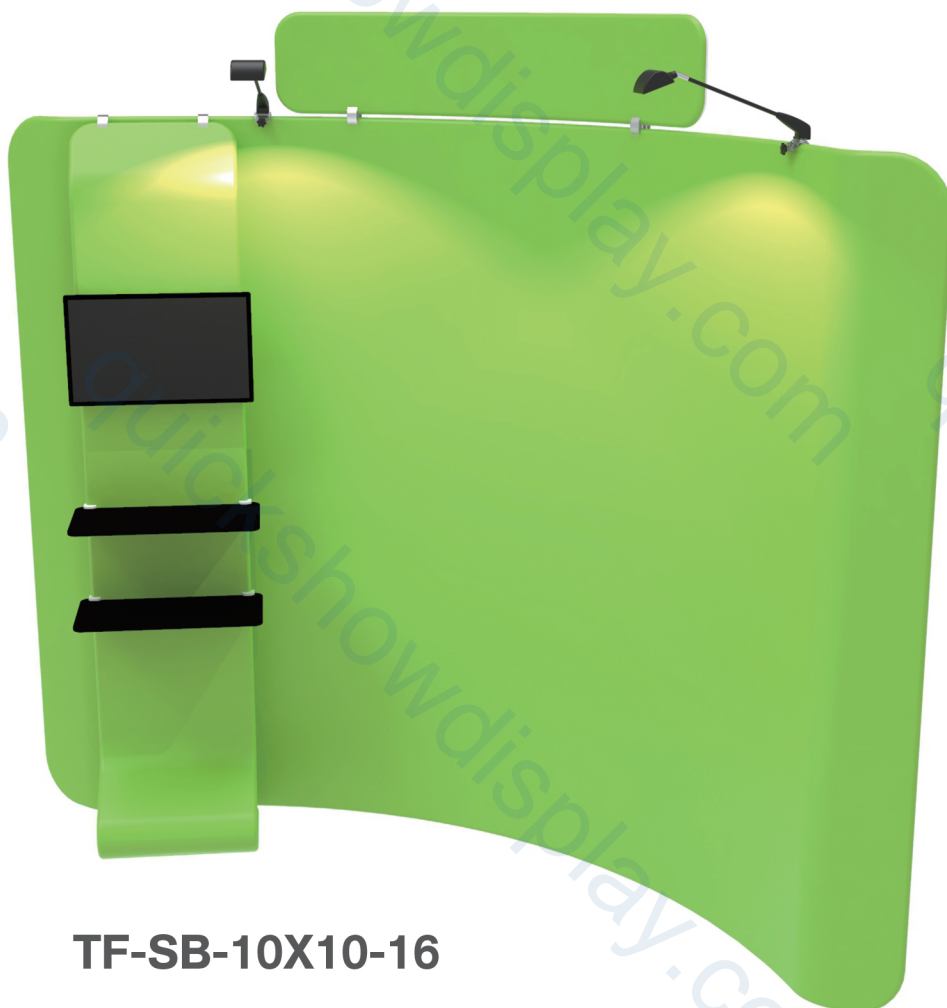
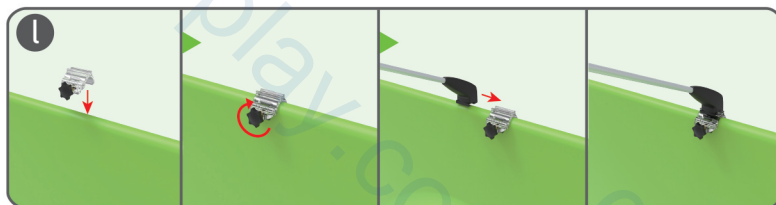

TF-SB-10X10-16

STEPS

(1) Durable Plastic Hard Case, Aluminum Support Poles



(2) Printed Graphic Fabric Banner



STEP 01

Put hard case's top into fabric banner.

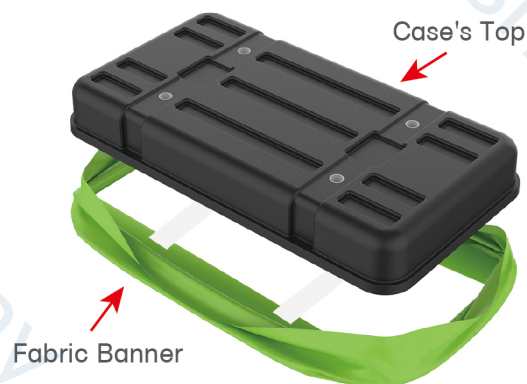

STEP 02

Insert support poles into hard case's top & bottom.

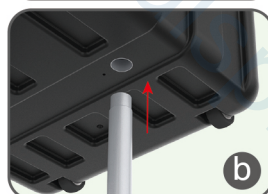
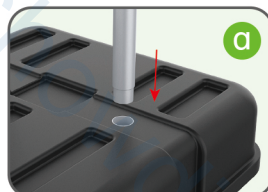
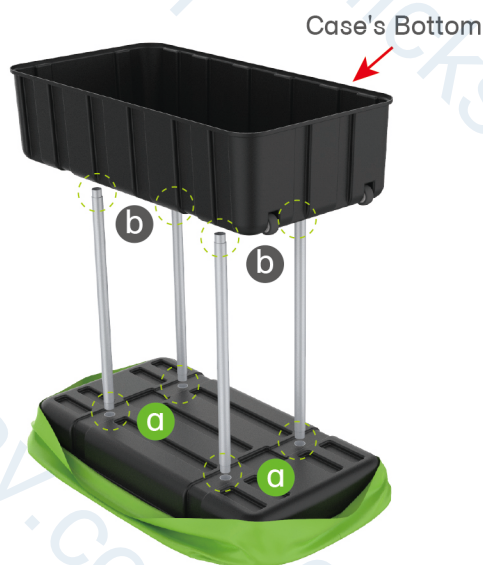

STEPS

STEP 04

Wrap fabric banner from bottom to top & twist it to be smooth, lay hard case's intermediate panel on podium's top.

